

YOU GOT TO GRANT IT TO GRANSA



CENTRIFUGAL
MONOBLOCK PUMPS
- 50 Hz

COMPANY PROFILE



YOU GOT TO GRANT IT TO GRANSA

First things first. Gransa is not your run-of-the-mill pump. It is the best there is. Period. In fact it is much more than just pumps. It is a movement. A revolution that can bring about change in the way we look at pumping technology. Gransa incorporates inspired design with new generation technology to ensure perfection at every level. Aesthetically pleasing with its sleek hi-tech looks, every Gransa pump is a marvel of workmanship and design and technologically superior. Functionally, Gransa is in a class all its own. The performance parameters are legendary and would leave you awe struck. It is not for nothing that it is said: you got to grant it to Gransa!

The Gransa quality edge comes from our collective attitude that will not compromise, will not accept second best, will not take no for an answer and will not rest until the perfect solution is found. Every single product bears the imprint of this commitment. Right from sourcing raw material to the finished product every step is



monitored both online and offline till it meets our exacting standards. We know that there is a lot riding on the quality of the raw material used in the manufacture of the pump. That is why we invest more time and money in sourcing the finest raw material available to give you a pump that is perfect in all respects. Another area where our pumps score is in energy efficiency. In these days of depleting energy resources, we believe that it is imperative that power saving should be central to your buying decision.

The fact that the manufacturing facilities are quite extensive and state of the art makes a big difference. The infrastructure is one of the best in the world - CI foundry, fully mechanized and Steel automated Foundry, world class R&D facilities with flow dynamic software, ISO 9001 & 14001 Certified production environment, highly skilled and qualified hands and more. All contributing to a production capacity of over 1 million pumps per annum.

The range is extensive. Applications include irrigation, domestic, civil construction, de-watering, Fire fighting, HVAC, Industrial etc. Our 4" to 8" borehole submersible pumps meet NEMA standards.

Gransa, in keeping with its reputation as a global brand has a wide network across strategic locations worldwide with an extensive dealer presence and service support centers.

GENERAL INFORMATION

IDENTIFICATION

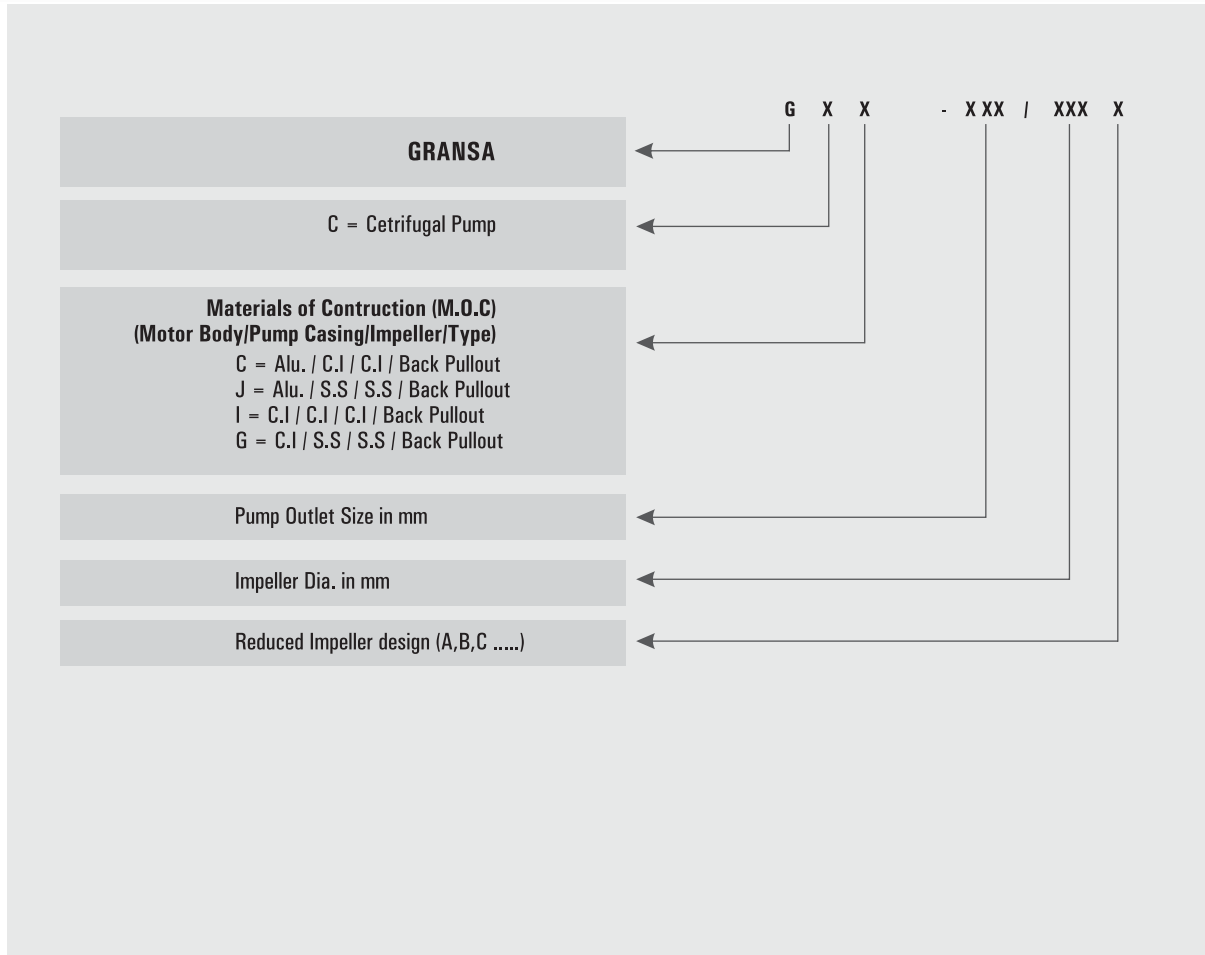

CENTRIFUGAL PUMPS - DIN STANDARD SINGLE SHAFT

GC SERIES - 3 PHASE

Gransa Centrifugal pump's volute chamber and impellers are carefully designed to give the best possible hydraulic and suction lift characteristics. All dimensions and performances are according to EN733- DIN 24255 standards. Most modern and highly sophisticated machinery and technology are employed in the manufacture of these pumps using quality raw material, dynamically balanced impellers, seals and ball bearings to ensure long life. Dynamically balanced rotor ensures vibration and noise free operation. Shaft is made of quality steel, precision ground of ample size for transmitting the rated Horse Power.

Features :

- | Overall dimensions and performances are according to EN733- DIN 24255 standards
- | High Suction lift characteristics
- | Good suction lift characteristics
- | Dynamically balanced rotating parts including rotor and impeller
- | Balanced and rigid construction

Applications :

- | Irrigation
- | Farms
- | Industrial Water Supply
- | General Water Supply
- | Drip and Sprinkler Systems
- | Water Treatment Plants
- | Residential

Specifications :

Power Range (kW)	2.2 kW to 30 kW
Speed	2900 rpm
Degree of Protection	IP 55
Class of insulation	"F" / "B"
Versions	Three Phase, 380-415V, 50Hz A.C Supply
Type of Duty	S1 (Continuous)
Direction of Rotation	Clock wise viewed from driving end
Nominal Suction & Delivery Size (mm)	50 x 32 65 x 40 65 x 50 80 x 65 80 x 80 100 x 80

Materials of Construction :

Pump Casing	Cast Iron
Motor Frame	Aluminum (upto 7.5kW) and Cast Iron (9.3kW & above)
Impeller	Cast Iron / Bronze
Shaft	2 Cr 13 (S.S.)
Mechanical Seal	Carbon & Ceramic

Pump Operating Limits :

Maximum Head	95 m / 308 ft
Maximum Suction lift	7 m
Operating Temperature	-15°C to +90°C
Maximum Ambient Temperature	40°C

CENTRIFUGAL PUMPS - DIN STANDARD SINGLE SHAFT

GC SERIES

PERFORMANCE CURVES

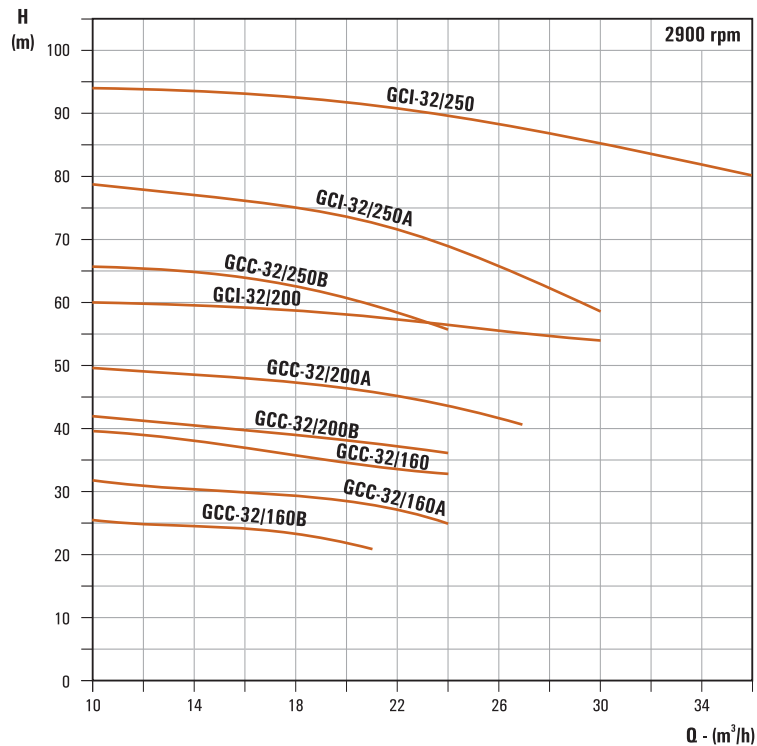

PERFORMANCE TABLE

Pipe Size in mm (Suc. x Del.) : 50 x 32

Model	kW	HP	Discharge										
			Ips	2.5	3.33	4.17	5	5.83	6.67	7.5	8.33	9.17	10
			m³/h	9	12	15	18	21	24	27	30	33	36
GCC-32/160B	2.2	3	Head in metres	25.8	25	24	22.5	21	-	-	-	-	-
GCC-32/160A	3	4		32	31	30	28.5	27	25	-	-	-	-
GCC-32/160	4	5.5		39.7	39	37.7	36.4	34	33	-	-	-	-
GCC-32/200B	5.5	7.5		42	41	40	39	37.5	36	-	-	-	-
GCC-32/200A	7.5	10		49.5	49	48	47	46	44	41.5	-	-	-
GCI-32/200	11	15		60	59.5	59	58	57.8	56	55	54	-	-
GCC-32/250B	7.5	10		65.5	65	64.5	62.5	59.5	58	55.5	-	-	-
GCI-32/250A	11	15		78	77	76.5	75	73	68	64	58	-	-
GCI-32/250	15	20		94	93.8	93	92.5	92	91	88	85	81.5	80

Note : The motor body is aluminum for upto 7.5kW & Cast Iron for 9.3kW & above. On Request aluminum motor body can also be supplied for above 7.5kW.

Curve tolerance according to ISO 9906, Annex A.

The performance data are at rated voltage and only indicative. Actual discharge depends on availability of water / tank, height of water column from the suction pipe end. The information / descriptions / specifications / illustrations are subject to change due to further improvements in the product.

CENTRIFUGAL PUMPS - DIN STANDARD SINGLE SHAFT

GC SERIES

PERFORMANCE CURVES

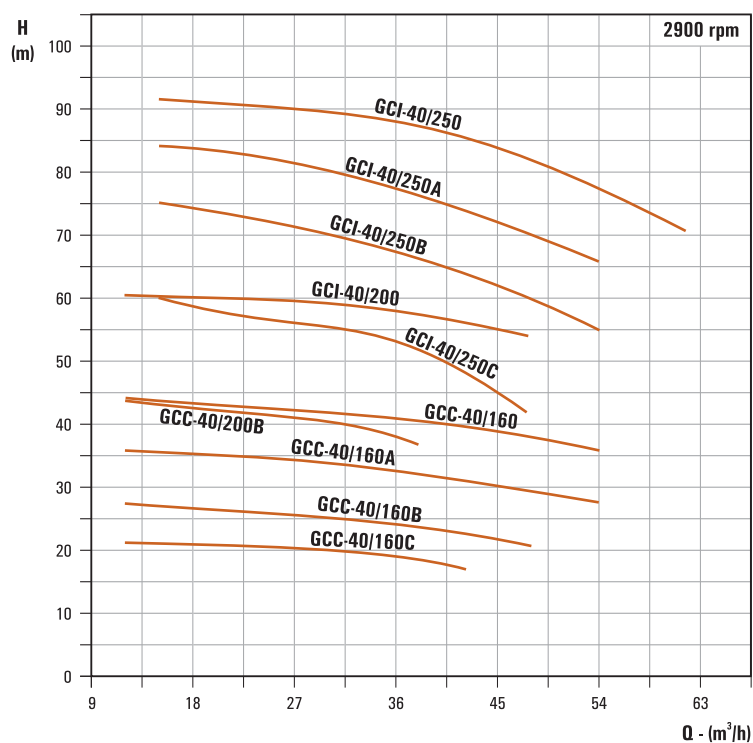

PERFORMANCE TABLE

Pipe Size in mm (Suc. x Del.) : 65 x 40

Model	kW	HP	Discharge														
			Ips	3.33	4.17	5	5.83	6.67	7.5	8.33	9.17	10	10.83	11.67	13.33	15	16.67
			m³/h	12	15	18	21	24	27	30	33	36	39	42	48	54	60
GCC-40/160C	3	4	Head in metres	21.5	21.3	21	20.8	20.5	20	19.8	19.5	19	18	17.5	-	-	-
GCC-40/160B	4	5.5		27.5	27	26.5	26.2	26	25.5	25	24.5	24	23.3	23	21	-	-
GCC-40/160A	4	5.5		36	35.8	35.6	35	34.8	34.2	33.8	33.5	32.4	32	31.6	29.5	27.5	-
GCC-40/160	7.5	10		44	43.8	43.5	43.3	43	42.6	42.2	42	41.5	41	40	38	36	-
GCC-40/200B	5.5	7.5		43.5	43	42.5	42	41.5	41	40.5	39.5	38.5	37	-	-	-	-
GCI-40/200	15	20		60.5	60.3	60.2	60	59.8	59.5	59	58.6	58	57	56.5	54	-	-
GCI-40/250C	11	15			60	59	58	57	56	55	54	53	50	47	42	-	-
GCI-40/250B	15	20			75	74	73.5	72.5	72	82	69.5	68	66	65	61	55	-
GCI-40/250A	18.5	25			84	83.5	83	82.5	82	80	78.5	77	76	75	72	66	-
GCI-40/250	22	30			92	91	90.5	90	89.8	59	88.5	87.5	87	86	82	77	71

Curve tolerance according to ISO 9906, Annex A.

The performance data are at rated voltage and only indicative. Actual discharge depends on availability of water / tank, height of water column from the suction pipe end.

The information / descriptions / specifications / illustrations are subject to change due to further improvements in the product.

CENTRIFUGAL PUMPS - DIN STANDARD SINGLE SHAFT

GC SERIES

PERFORMANCE CURVES

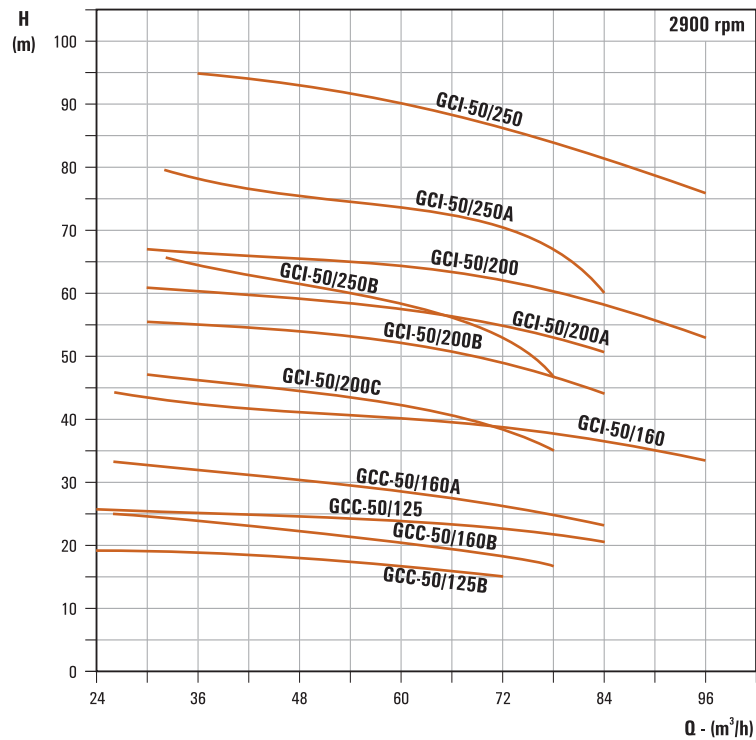

PERFORMANCE TABLE

Pipe Size in mm (Suc. x Del.) : 65 x 50

Model	kW	HP	Discharge																
			Ips	6.67	7.5	8.33	9.17	10	10.83	11.67	13.33	15	16.67	18.33	20	21.67	23.33	26.67	
			m³/h	24	27	30	33	36	39	42	48	54	60	66	72	78	84	96	
GCC-50/125B	4	5.5	Head in metres	19.1	19	18.8	18.7	18.5	18.2	18	17.3	17	16.4	15.7	15	-	-	-	
GCC-50/125	7.5	10		25.9	25.8	25.5	25.4	25.2	25.1	25	24.5	24	23.6	23.2	22.8	22	20.6	-	
GCC-50/160B	5.5	7.5			25	24.2	24	23.8	23.5	23	22	21	20.5	19.5	18.5	17	-	-	
GCC-50/160A	7.5	10			33.5	33	32.8	32.3	32	31.5	30.5	29.5	28.5	27.5	26.5	25	23.5	-	
GCI-50/160	11	15			43.8	43.5	43	42.5	42.2	42	41.5	41	40	39	38.2	37	36	33.5	
GCI-50/200C	9.3	12.5					47	46.5	46	45.5	45	44	43	42	40.5	38	35	-	-
GCI-50/200B	15	20					55.5	55.4	55.2	55	54.5	54	53	52	50.5	48.5	46	44	-
GCI-50/200A	18.5	25					61	60.7	60.5	60.3	60	59	58	57	56.5	55	52.5	51	-
GCI-50/200	22	30					67	66.8	66.5	66	65.8	65.5	65	64.5	63.5	62	58	57	53
GCI-50/250B	18.5	25						65.5	65	64.5	64	62	60	58	56.5	53	47	-	-
GCI-50/250A	22	30						79	78.5	78	77.5	75	74	72.5	71	67	63	60	-
GCI-50/250	30	40							95	94.5	94	93.5	92	90	88	85	80	74	

Curve tolerance according to ISO 9906, Annex A.

The performance data are at rated voltage and only indicative. Actual discharge depends on availability of water / tank, height of water column from the suction pipe end.

The information / descriptions / specifications / illustrations are subject to change due to further improvements in the product.

CENTRIFUGAL PUMPS - DIN STANDARD SINGLE SHAFT

GC SERIES

PERFORMANCE CURVES

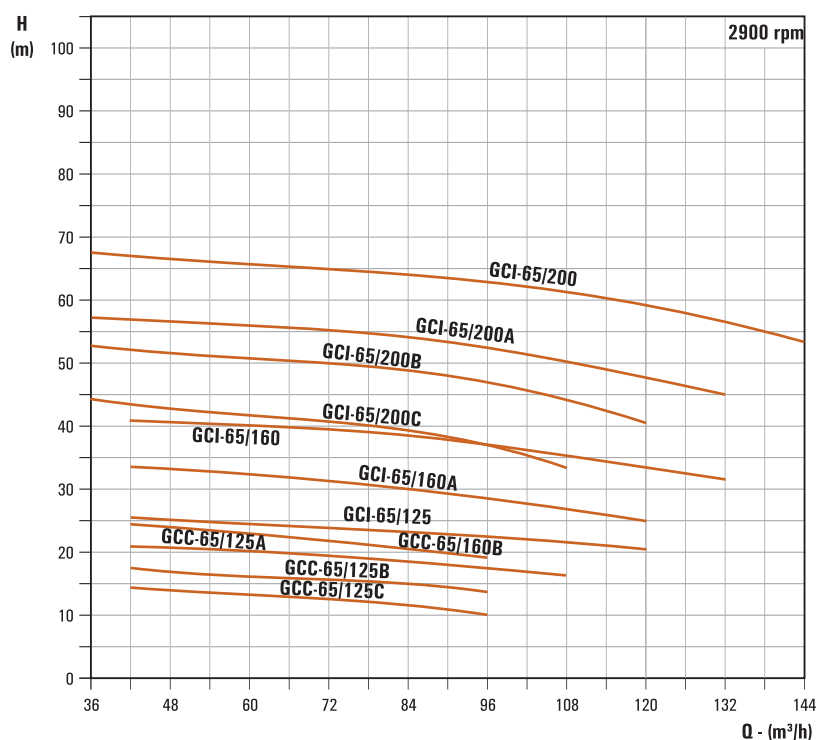

PERFORMANCE TABLE

Pipe Size in mm (Suc. x Del.) : 80 x 65 / 80 x 80

Model	kW	HP	Discharge															
			lps	10	10.83	11.67	13.33	15	16.67	18.33	20	21.67	23.33	26.67	30	30.33	36.67	40
			m³/h	36	39	42	48	54	60	66	72	78	84	96	108	120	132	144
GCC-65/125C	4	5.5	Head in metres	-	-	14	13.8	13.5	13.2	13	12.5	12	11.8	10	10	-	-	-
GCC-65/125B	5.5	7.5		-	-	17.2	17	16.8	16.5	16.2	16	15.5	15	14	14	-	-	-
GCC-65/125A	5.5	7.5		-	-	21	20.8	20.5	20.2	20	19.5	19	18.6	18	16.5	-	-	-
GCI-65/125	11	15		-	-	25.4	25	24.8	24.6	24.5	24.2	24	23.5	23	21.8	20.5	-	-
GCC-65/160B	7.5	10		-	-	24.5	24	23.5	23	22.5	22	21	20.5	19	19	-	-	-
GCI-65/160A	11	15		-	-	33.5	33	32.8	32.5	32	31	30.5	30	29	29	25	-	-
GCI-65/160	15	20		-	-	41.5	41	40.5	40.2	40	39.5	39	38.5	37	37	34	32	-
GCI-65/200C	15	20		44	43.8	43.5	43	42.5	42.2	42	41	40	39	37	37	-	-	-
GCI-65/200B	18.5	25		52.5	52.2	52	51.8	51.5	51	50.5	50	49	48.5	47	47	41	-	-
GCI-65/200A	22	30		57	56.7	56.5	56.4	56.2	56	55.5	55	54.2	54	52	52	48	45	-
GCI-65/200	30	40	67.3	67	66.5	66.4	66.2	66	65.5	65	64.5	64	63	63	59	57	53	

Curve tolerance according to ISO 9906, Annex A.

The performance data are at rated voltage and only indicative. Actual discharge depends on availability of water / tank, height of water column from the suction pipe end.

The information / descriptions / specifications / illustrations are subject to change due to further improvements in the product.

CENTRIFUGAL PUMPS - DIN STANDARD SINGLE SHAFT

GC SERIES

PERFORMANCE CURVES

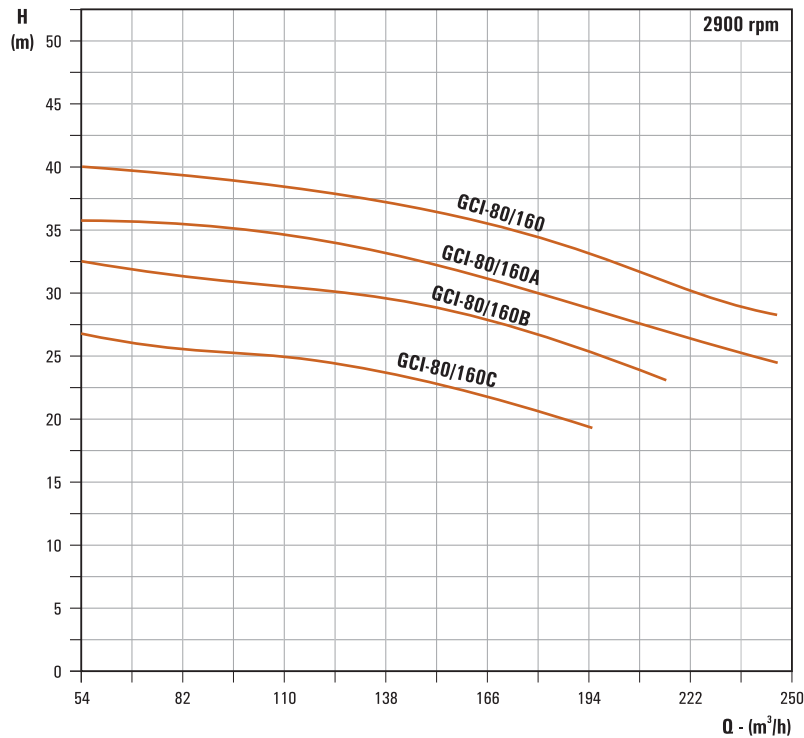

PERFORMANCE TABLE

Pipe Size in mm (Suc. x Del.) : 100 x 80

Model	kW	HP	Discharge								
			Ips	15	20	26.67	30.33	40	54.17	60	68.33
			m³/h	54	72	96	120	144	195	216	246
GCI-80/160C	15	20	Head in metres	27	26.5	25.4	24.5	23	19	-	-
GCI-80/160B	18.5	25		32.5	32	31	30.5	29	25	23	-
GCI-80/160A	22	30		36	35.5	35	34	32.5	28.5	27	24
GCI-80/160	30	40		40	39.5	39	38	37	33	31	28

Curve tolerance according to ISO 9906, Annex A.

The performance data are at rated voltage and only indicative. Actual discharge depends on availability of water / tank, height of water column from the suction pipe end. The information / descriptions / specifications / illustrations are subject to change due to further improvements in the product.

CENTRIFUGAL PUMPS - DIN STANDARD SINGLE SHAFT

GC SERIES

DIMENSIONAL DRAWING

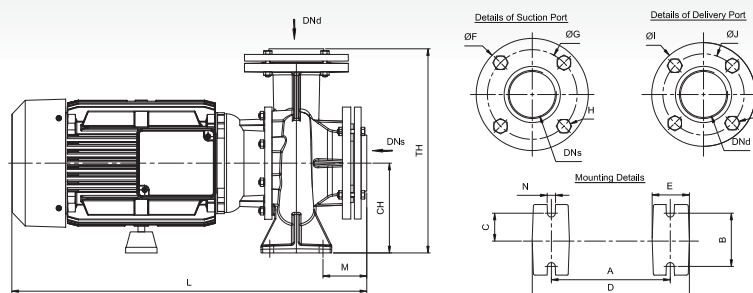

DIMENSIONAL DATA

Model	kW	DNs	DNd	L	CH	TH	A	B	C	D	E	M	N	ØF	ØG	H	ØI	ØJ	ØK
GCC-32/160B	2.2	50	32	475	132	315	190	70	35	240	50	68	14	165	125	18	140	100	18
GCC-32/160A	3	50	32	500	132	315	190	70	35	240	50	68	14	165	125	18	140	100	18
GCC-32/160	4	50	32	550	132	315	190	70	35	240	50	68	14	165	125	18	140	100	18
GCC-32/200B	5.5	50	32	575	160	365	190	70	35	240	50	68	14	165	125	18	140	100	18
GCC-32/200A	7.5	50	32	575	160	365	190	70	35	240	50	68	14	165	125	18	140	100	18
GCI-32/200	11	50	32	630	160	365	190	70	35	240	50	68	14	165	125	18	140	100	18
GCC-32/250B	7.5	50	32	595	180	430	250	95	47.5	320	65	76	14	165	125	18	140	100	18
GCI-32/250A	11	50	32	650	180	430	250	95	47.5	320	65	76	14	165	125	18	140	100	18
GCI-32/250	15	50	32	650	180	430	250	95	47.5	320	65	76	14	165	125	18	140	100	18
GCC-40/160C	3	65	40	500	132	315	190	70	35	240	50	68	14	185	145	18	150	110	18
GCC-40/160B	4	65	40	550	132	315	190	70	35	240	50	68	14	185	145	18	150	110	18
GCC-40/160A	4	65	40	575	132	315	190	70	35	240	50	68	14	185	145	18	150	110	18
GCC-40/160	7.5	65	40	575	132	315	190	70	35	240	50	68	14	185	145	18	150	110	18
GCC-40/200B	5.5	65	40	590	160	365	212	70	35	265	50	88	14	185	145	18	150	110	18
GCI-40/200	15	65	40	670	160	365	212	70	35	265	50	88	14	185	145	18	150	110	18
GCI-40/250C	11	65	40	650	180	430	250	95	47.5	320	65	76	14	185	145	18	150	110	18
GCI-40/250B	15	65	40	650	180	430	250	95	47.5	320	65	76	14	185	145	18	150	110	18
GCI-40/250A	18.5	65	40	650	180	430	250	95	47.5	320	65	76	14	185	145	18	150	110	18
GCI-40/250	22	65	40	650	180	430	250	95	47.5	320	65	76	14	185	145	18	150	110	18
GCC-50/125B	4	65	50	560	132	315	190	70	35	240	50	68	14	185	145	18	165	125	18
GCC-50/125	7.5	65	50	595	132	315	190	70	35	240	50	68	14	185	145	18	165	125	18
GCC-50/160B	5.5	65	50	595	160	365	212	70	35	265	50	88	14	185	145	18	165	125	18
GCC-50/160A	7.5	65	50	595	160	365	212	70	35	265	50	88	14	185	145	18	165	125	18
GCI-50/160	11	65	50	685	160	365	212	70	35	265	50	88	14	185	145	18	165	125	18
GCI-50/200C	9.3	65	50	670	160	365	212	70	35	265	50	88	14	185	145	18	165	125	18
GCI-50/200B	15	65	50	670	160	365	212	70	35	265	50	88	14	185	145	18	165	125	18
GCI-50/200A	18.5	65	50	670	160	365	212	70	35	265	50	88	14	185	145	18	165	125	18
GCI-50/200	22	65	50	650	160	365	212	70	35	265	50	88	14	185	145	18	165	125	18
GCI-50/250B	18.5	65	50	650	180	430	250	95	47.5	320	65	76	14	185	145	18	165	125	18
GCI-50/250A	22	65	50	650	180	430	250	95	47.5	320	65	76	14	185	145	18	165	125	18
GCI-50/250	30	65	50	970	180	430	250	95	47.5	320	65	76	14	185	145	18	165	125	18
GCC-65/125C	4	80	65	560	180	365	212	95	47.5	280	65	76	14	200	160	18	185	145	18
GCC-65/125B	5.5	80	65	595	180	365	212	95	47.5	280	65	76	14	200	160	18	185	145	18
GCC-65/125A	5.5	80	65	595	180	365	212	95	47.5	280	65	76	14	200	160	18	185	145	18
GCI-65/125	11	80	65	690	180	365	212	95	47.5	280	65	76	14	200	160	18	185	145	18
GCC-65/160B	7.5	80	65	590	160	385	212	95	47.5	280	65	76	14	200	160	18	185	145	18
GCI-65/160A	11	80	65	690	160	385	212	95	47.5	280	65	76	14	200	160	18	185	145	18
GCI-65/160	15	80	65	690	160	385	212	95	47.5	280	65	76	14	200	160	18	185	145	18
GCI-65/200C	15	80	65	690	180	430	250	95	47.5	320	65	76	14	200	160	18	185	145	18
GCI-65/200B	18.5	80	65	690	180	430	250	95	47.5	320	65	76	14	200	160	18	185	145	18
GCI-65/200A	22	80	65	750	180	430	250	95	47.5	320	65	76	14	200	160	18	185	145	18
GCI-65/200	30	80	65	970	180	430	250	95	47.5	320	65	76	14	200	160	18	185	145	18
GCI-80/160C	15	100	80	690	180	430	250	95	47.5	320	65	76	14	220	180	18	200	160	18
GCI-80/160B	18.5	100	80	690	180	430	250	95	47.5	320	65	76	14	220	180	18	200	160	18
GCI-80/160A	22	100	80	750	180	430	250	95	47.5	320	65	76	14	220	180	18	200	160	18
GCI-80/160	30	100	80	970	180	430	250	95	47.5	320	65	76	14	220	180	18	200	160	18

CENTRIFUGAL PUMPS - STAINLESS STEEL DIN STANDARD SINGLE SHAFT

GC SERIES

Gransa Centrifugal pump's volute chamber and impellers are carefully designed to give the best possible hydraulic and suction lift characteristics. All dimensions are according to DIN 24255 standards. Most modern and highly sophisticated machinery and technology are employed in the manufacture of these pumps using quality raw material, dynamically balanced impellers, seals and ball bearings to ensure long life. Dynamically balanced rotor ensures vibration and noise free operation. Shaft is made of quality steel, precision ground of ample size for transmitting the rated Horse Power. The pump portion is made of complete stainless steel construction which are more suitable for potable water.

Features :

- | All wetted components are made of corrosion resistance stainless steel.
- | Designed to give best hydraulic efficiency and suction lift characteristics.
- | Wear resistant bearing ensure noiseless operation.
- | Back pull out design facilitates dismantling the pump without disconnecting the pipe lines.
- | DIN Standard flange connections.

Applications :

- | Industrial water supply
- | Food processing industries
- | Pressure boosting units
- | HVAC
- | Washing systems
- | Irrigation etc.,

Specifications :

Power Range (kW)	1.1 kW to 18.5 kW
Speed	2900 rpm
Degree of Protection	IP 55
Class of insulation	"F"
Versions	1Ph, 230V & 3 Ph, 380-415V - 50Hz A.C Supply
Type of Duty	S1 (Continuous)
Direction of Rotation	Clock wise viewed from driving end
Nominal Suction & Delivery Size (mm)	50 x 32 65 x 40 65 x 50

Materials of Construction :

Pump Casing	S.S 304 / S.S 316
Motor Frame	Aluminum (Upto 15kW) and Cast Iron (18.5kW)
Impeller	S.S 304 / S.S 316
Shaft	S.S. 304
Mechanical Seal	Carbon & Ceramic

Pump Operating Limits :

Maximum Head	73 m / 239 ft
Maximum Suction lift	7 m
Operating Temperature	0°C to 70°C
Maximum Ambient Temperature	40°C
Maximum Working Pressure	10 Bar

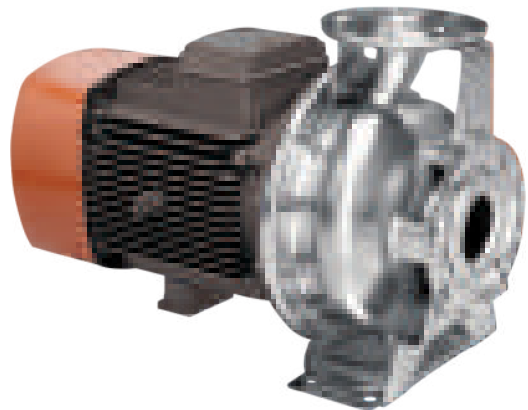

CENTRIFUGAL PUMPS - STAINLESS STEEL DIN STANDARD SINGLE SHAFT

GC SERIES

PERFORMANCE CURVES

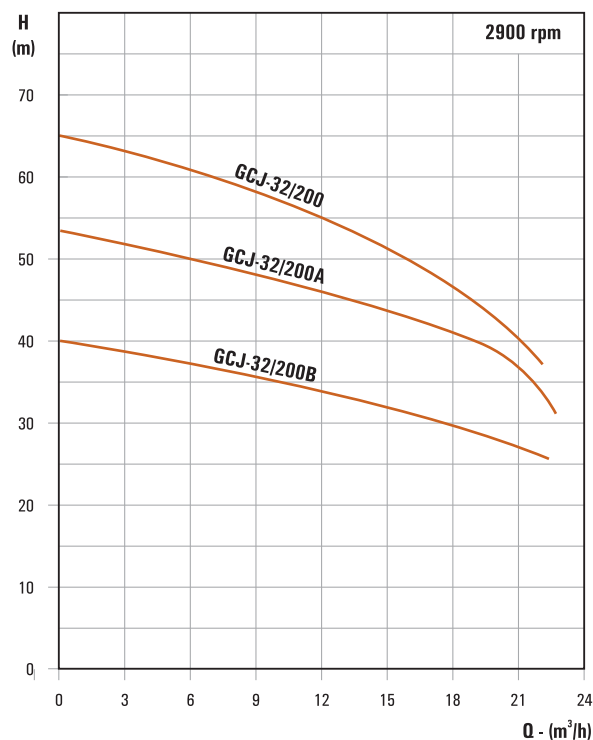
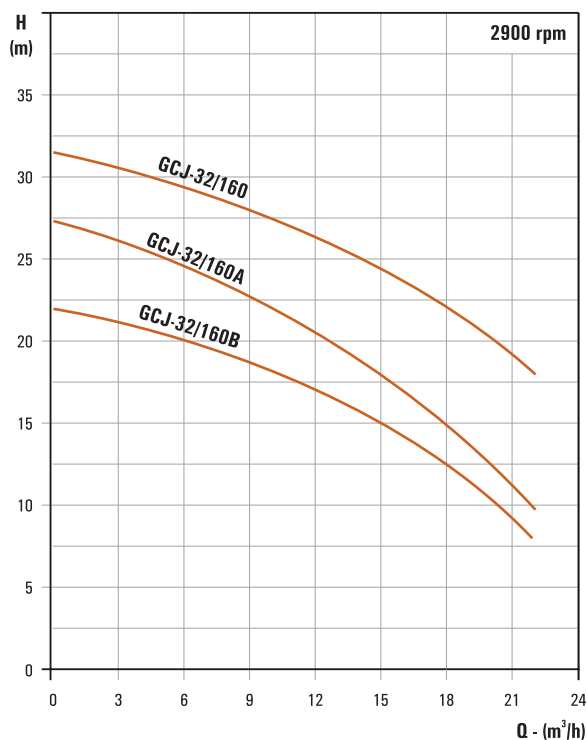

PERFORMANCE TABLE

Pipe Size in mm (Suc. x Del.) : 50 x 32

Model	kW	HP	Discharge								
			Ips	0.83	1.67	2.5	3.47	4.17	5	5.56	6.11
			m³/h	3	6	9	12.5	15	18	20	22
GCJ-32/160B	1.1	1.5	Head in metres	21	20	18.5	16.5	15	12.5	10	8
GCJ-32/160A	1.5	2.0		26	24.5	22.5	20	18.5	15	12.5	9.5
GCJ-32/160	2.2	3.0		30.5	29.5	27.5	26	24	22.5	20.5	18
GCJ-32/200B	3.0	4.0		38	37	35	34	32	30	28	26
GCJ-32/200A	4.0	5.5		51.5	50	48	45	43	41	39	30
GCJ-32/200	5.5	7.5		62	60	58	54	52	47	42	37

Curve tolerance according to ISO 9906, Annex A.

The performance data are at rated voltage and only indicative. Actual discharge depends on availability of water / tank, height of water column from the suction pipe end.

The information / descriptions / specifications / illustrations are subject to change due to further improvements in the product.

CENTRIFUGAL PUMPS - STAINLESS STEEL DIN STANDARD SINGLE SHAFT

GC SERIES

PERFORMANCE CURVES

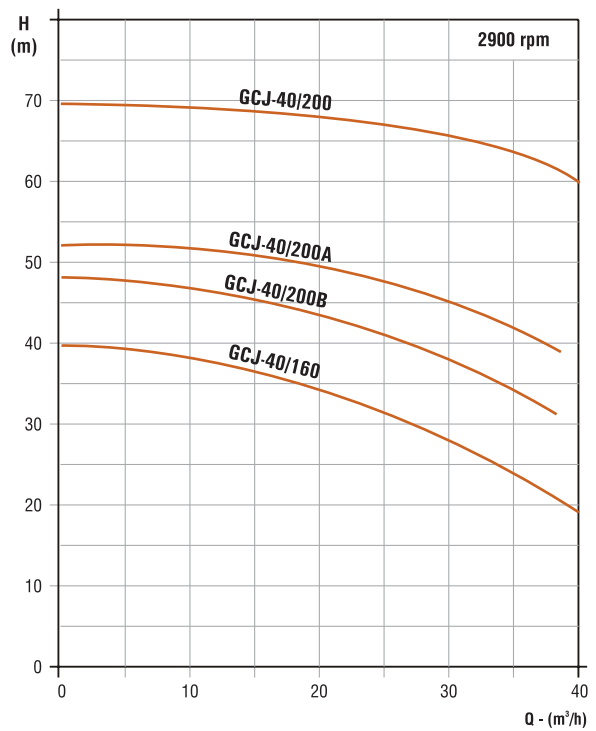
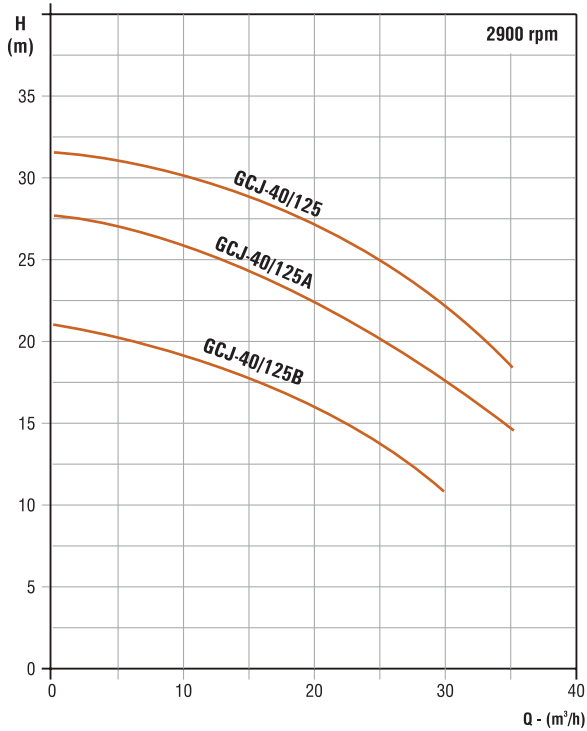

PERFORMANCE TABLE

Pipe Size in mm (Suc. x Del.) : 65 x 40

Model	kW	HP	Discharge								
			Ips	1.39	2.78	4.17	5.56	6.94	8.33	9.72	11.11
			m³/h	5	10	15	20	25	30	35	40
GCJ-40/125B	1.5	2.0	Head in metres	20	19	17.5	16	13	10.5	-	-
GCJ-40/125A	2.2	3.0		27	26	24	22	20	17	14	-
GCJ-40/125	3.0	4.0		31	30	29	27	25	22	18	-
GCJ-40/160	4.0	5.5		39	38	36.5	34	31	28	24	19
GCJ-40/200B	5.5	7.5		47	46	45.5	44	41	38	34	30
GCJ-40/200A	7.5	10		52	51.5	51	50	48	45	42	38
GCJ-40/200	11	15		69	69	68.5	68	68	66	64	60

Curve tolerance according to ISO 9906, Annex A.

The performance data are at rated voltage and only indicative. Actual discharge depends on availability of water / tank, height of water column from the suction pipe end.

The information / descriptions / specifications / illustrations are subject to change due to further improvements in the product.

CENTRIFUGAL PUMPS - STAINLESS STEEL DIN STANDARD SINGLE SHAFT

GC SERIES

PERFORMANCE CURVES

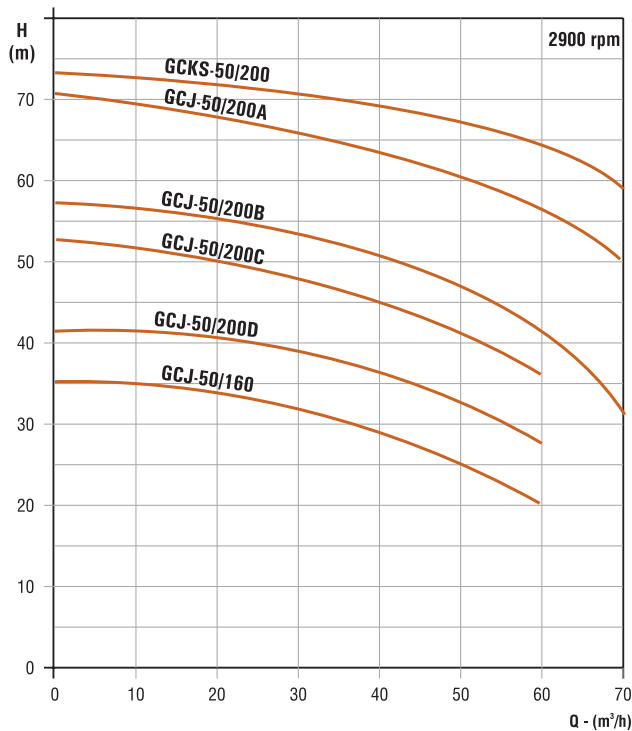
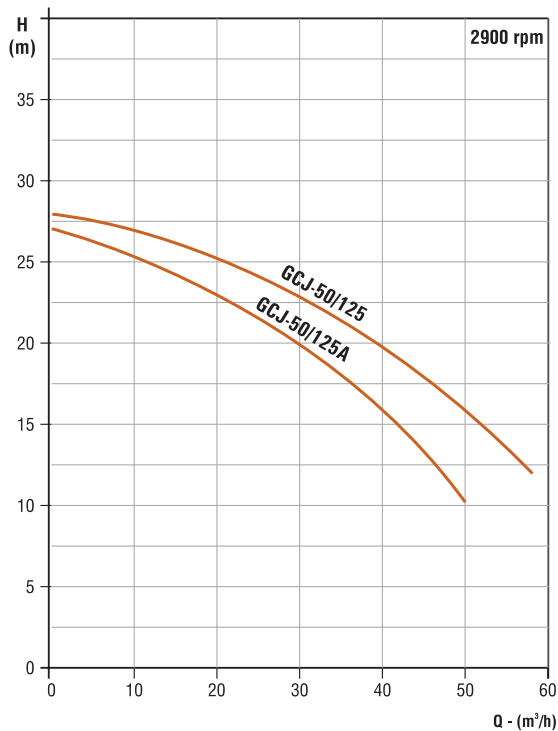

PERFORMANCE TABLE

Pipe Size in mm (Suc. x Del.) : 65 x 50

Model	kW	HP	Discharge								
			Ips	1.39	2.78	5.56	18.33	11.11	13.89	16.67	19.44
			m³/h	5	10	20	30	40	50	60	70
GCJ-50/125A	3.0	4.0	Head in metres	27	26	23	20	16	10	-	-
GCJ-50/125	4.0	5.5		28	27	26	24	21	16	-	-
GCJ-50/160	5.5	7.5		34.5	34.5	34	31.5	28.5	24	20	-
GCJ-50/200D	7.5	10		41	41	40.5	39	36	32	27.5	-
GCJ-50/200C	9.2	12.5		52	52	51	49	45	41	37	-
GCJ-50/200B	11	15		57	56	55	53	51	48	42	30
GCJ-50/200A	15	20		69	68	67	65	64	62	57	50
GCG-50/200	18.5	25		73	72	71	70	69	68	65	59

Curve tolerance according to ISO 9906, Annex A.

The performance data are at rated voltage and only indicative. Actual discharge depends on availability of water / tank, height of water column from the suction pipe end.

The information / descriptions / specifications / illustrations are subject to change due to further improvements in the product.

CENTRIFUGAL PUMPS - STAINLESS STEEL DIN STANDARD SINGLE SHAFT

GC SERIES

DIMENSIONAL DRAWING

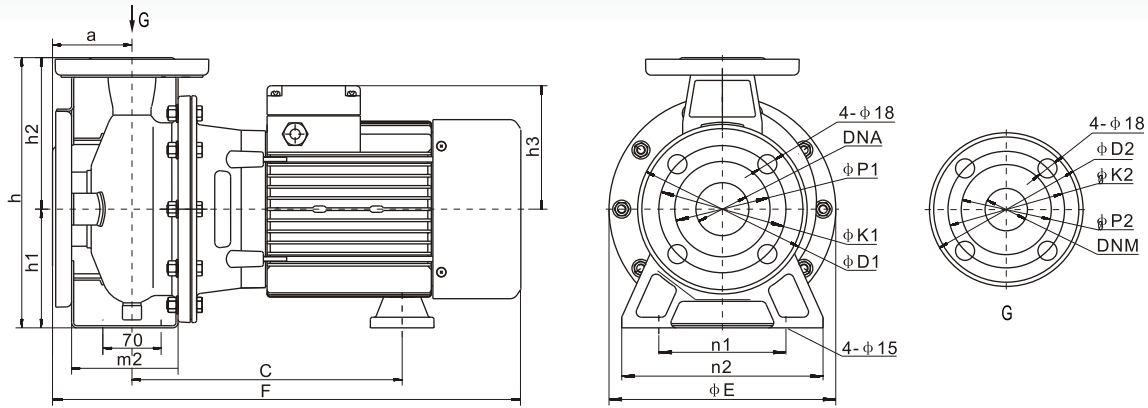

DIMENSIONAL DATA

Model	kW	ϕE	F	h	h ₁	h ₂	h ₃	a	m ₂	n ₁	n ₂	C	$\phi D1$	$\phi K1$	$\phi P1$	$\phi D2$	$\phi K2$	$\phi P2$	DN _s	DN _d	Wt. in kg
GCJ-32/160B	1.1	210	395	255	112	143	134	80	115	160	190	215	165	125	96	140	100	76	50	32	19.7
GCJ-32/160A	1.5	210	395	255	112	143	134	80	115	160	190	215	165	125	96	140	100	76	50	32	23
GCJ-32/160	2.2	210	438	255	112	143	119	80	118	160	190	245	165	125	96	140	100	76	50	32	27.7
GCJ-32/200B	3.0	300	450	340	160	180	119	80	118	190	240	245	165	125	96	140	100	76	50	32	35.5
GCJ-32/200A	4.0	300	498	340	160	180	142	80	118	190	240	257	165	125	96	140	100	76	50	32	56.3
GCJ-32/200	5.5	300	532	340	160	180	162	80	115	190	240	272	165	125	96	140	100	76	50	32	67.4
GCJ-40/125B	1.5	210	395	255	112	143	134	80	115	160	190	215	185	145	115	150	110	80	65	40	23
GCJ-40/125A	2.2	210	438	255	112	143	119	80	118	160	190	245	185	145	115	150	110	80	65	40	26.5
GCJ-40/125	3.0	260	450	295	132	160	119	80	118	190	240	245	185	145	115	150	110	80	65	40	32
GCJ-40/160	4.0	260	498	295	132	160	142	80	118	190	240	258	185	145	115	150	110	80	65	40	53.8
GCJ-40/200B	5.5	300	554	360	160	200	162	100	118	212	264	274	185	145	115	150	110	80	65	40	67.5
GCJ-40/200A	7.5	300	595	360	160	200	162	100	118	212	264	274	185	145	115	150	110	80	65	40	78.6
GCJ-40/200	11	300	623	360	160	200	179	100	118	212	264	335	185	145	115	150	110	80	65	40	96
GCJ-50/125A	3.0	260	455	295	132	160	119	80	115	190	240	245	185	145	115	165	125	96	65	50	32.2
GCJ-50/125	4.0	260	498	295	132	160	142	80	115	190	240	258	185	145	115	165	125	96	65	50	54
GCJ-50/160	5.5	300	554	360	160	200	162	100	118	212	264	274	185	145	115	165	125	96	65	50	68
GCJ-50/200D	7.5	300	595	360	160	200	162	100	118	212	264	274	185	145	115	165	125	96	65	50	78.6
GCJ-50/200C	9.2	300	623	360	160	200	179	100	118	212	264	335	185	145	115	165	125	96	65	50	86.5
GCJ-50/200B	11	300	623	360	160	200	179	100	118	212	264	335	185	145	115	165	125	96	65	50	96
GCJ-50/200A	15	300	665	360	160	200	179	100	118	212	264	335	185	145	115	165	125	96	65	50	115
GCG-50/200	18.5	350	725	360	160	200	255	100	118	212	264	429	185	145	115	165	125	96	65	50	152

Notes :

Vision & Mission

To lead from the front and set the standard in providing fluid management solutions across a wide spectrum of industries across the globe. To make the world a better place by embracing viable, sustainable technologies and processes and enlightened business practices. Our experience, expertise, the quality of our people and, of course, our strong customer orientation would be factors that would leverage our efforts to achieve our ends and fulfil our avowed commitment to all our stakeholders.



Saravanampatti, Coimbatore, India - 641035. | Poligono Industrial El. Bony Calle 31,
Email: sales@gransaglobal.com | No. 137,46470 Catarroja (Valencia) Spain.
www.gransaglobal.com